

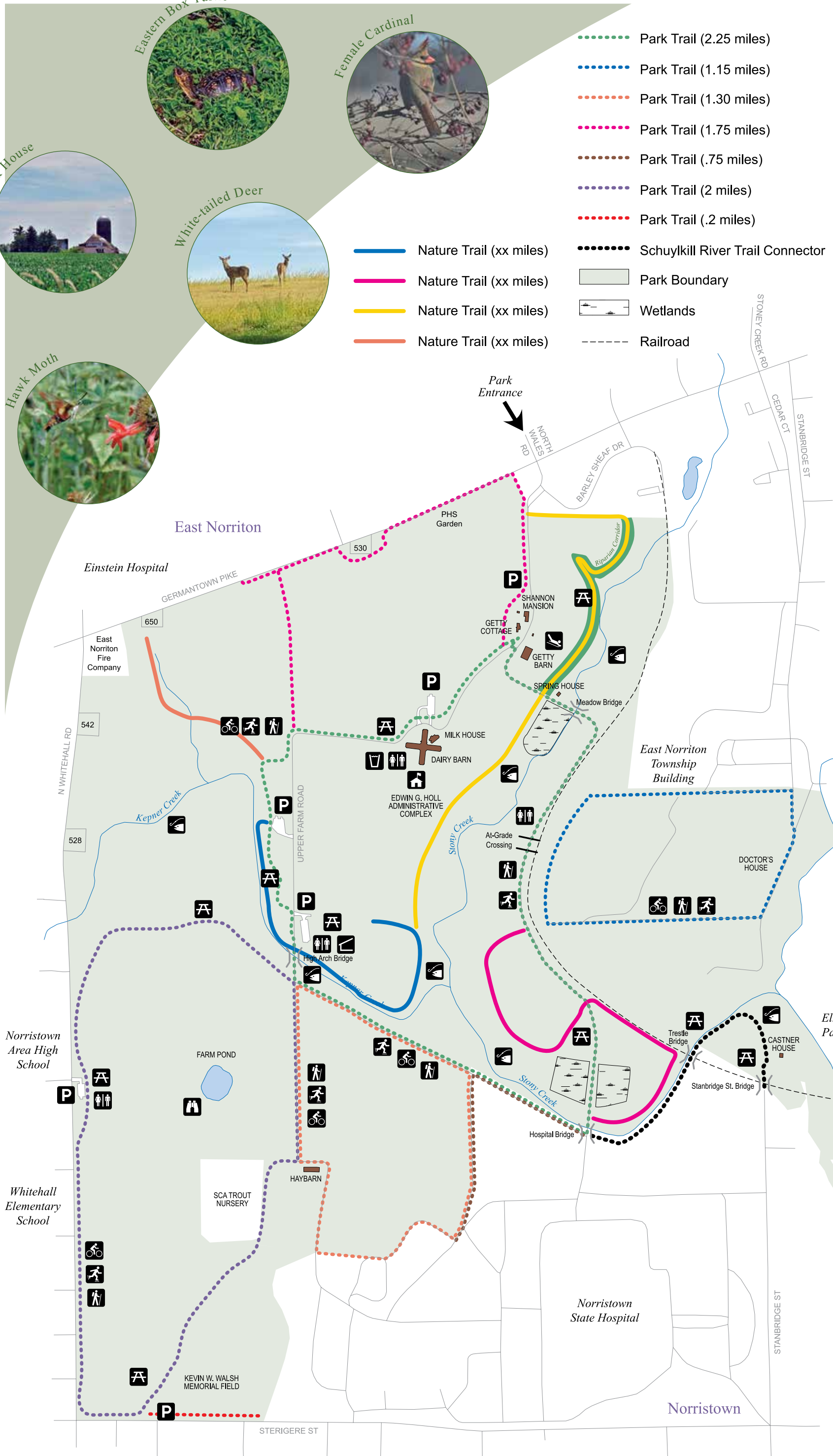

- ⋯ Park Trail (2.25 miles)
- ⋯ Park Trail (1.15 miles)
- ⋯ Park Trail (1.30 miles)
- ⋯ Park Trail (1.75 miles)
- ⋯ Park Trail (.75 miles)
- ⋯ Park Trail (2 miles)
- ⋯ Park Trail (.2 miles)
- Nature Trail (xx miles)
- Nature Trail (xx miles)
- Nature Trail (xx miles)
- Nature Trail (xx miles)
- ⋯ Schuylkill River Trail Connector
- Park Boundary
- Wetlands
- Railroad

- Bicycling
- Drinking fountain
- Fishing
- Hiking/Walking
- Parking
- Park office
- Pavillion
- Picnic area
- Inline Skating
- Restrooms
- Sledding
- Wildlife viewing



Multi-Use Trails
Approx. 8.0 miles in length.
Easy – Moderate.
 An interconnecting series of paved trails provides access to much of the park, both internally and externally. Views of the sites rolling topography, historic structures, streams, wetlands, woodlands, working and fallow farm fields, abound. These trails are relatively flat and are in most cases, accessible by wheelchair.

Red Nature Trail
Easy
 Trail begins just a few hundred feet from the at-grade crossing on Lower Farm Road and terminates at the Hospital Bridge. Trail is mostly wooded and offers views of Stony Creek, several wetlands, working farm fields and an elevated railroad trestle bridge which spans Stony Creek. Trail is relatively flat, surface is compacted earth.

Blue Nature Trail
Easy to Moderate
 Trail begins behind Parking Lot #2 and terminates behind the pavilions at Parking Lot #3. Mostly wooded, this trail parallels the (paved) Woodland Trail, as well as portions of Kepner and of Stony Creek. While relatively flat, this trail does contain one slope and a creek side crossing, closer to Lot # 2. Note: Rocks near the creek side crossing may be wet and slippery, please use caution in this area. Trail surface is compacted earth.

Yellow Nature Trail
Easy to Moderate
 Begins at the park's main entrance, terminating where it intersects with the Blue Trail, behind the pavilions/ Parking Lot # 3. Trail is both wooded and open. Features include, creek views, wetlands, a riparian corridor, working and fallow farm fields and the 1764 Springhouse. Trail surface is compacted earth.

Orange Nature Trail
Easy
 Located off the Woodland Trail on Upper Farm Road, just below the 90 degree bend, this trail runs beside active farm fields as it makes its way out to Germantown Pike. Trail surface is compacted earth. One-way, users must return via the same path.

West Norriton

